

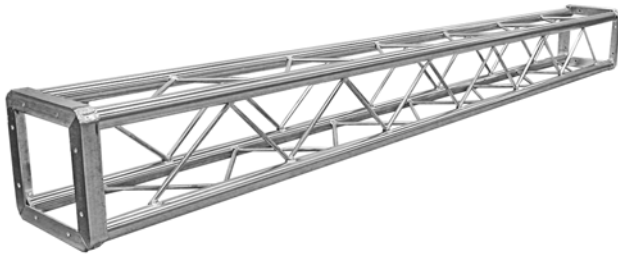

### EURO FEATURES

- Highly Polished Aluminum Tubing
- 1.9" OD 6061-T6 Aluminum Tube Schd #40
- 0.145" Wall Thickness
- 1/2" Solid Aluminum Rod Bracing
- 1-3/4" x 1/4" Aluminum End Plates
- Fabricated by Certified Welders
- Custom Lengths & Corners Available
- Powder Coating Available

Euro Box truss is manufactured with 1.9" OD main chords and 1/2" solid aluminum rod bracing. It is ideal for trade show booths, small venues, retail showrooms and other installations with light load limits. The highly polished aluminum finish blends with contemporary design elements or this truss can be powder coated to match any interior design scheme. The Architectural series of truss is ideal for circles, stars and other unique projects.



### ORDERING INFORMATION

Item No.	Dimensions	Weight
8-12-120	12" x 12" x 10'	51 lbs.
8-12-096	12" x 12" x 8'	44 lbs.
8-12-060	12" x 12" x 5'	29 lbs.
8-12-030	12" x 12" x 2.5'	13 lbs.
8-12-006	6-Way Corner	13 lbs.
8-16-120	16" x 16" x 10'	60 lbs.
8-16-096	16" x 16" x 8'	42 lbs.
8-16-060	16" x 16" x 5'	33 lbs.
8-16-030	16" x 16" x 2.5'	22 lbs.
8-16-006	6-Way Corner	18 lbs.

#### PLATED ALLOWABLE LOAD DATA

#### Maximum Allowable Uniform Loads



#### Maximum Allowable Center Point Loads



SPAN (ft.)	LOAD (#/ft.)	LOAD (#)	MAX. DEFL. (in.)	LOAD (#)	MAX. DEFL. (in.)
<b>12" x 12" Euro Box Truss Weight Loading Info</b>					
10	232	2320	0.07	2022	0.09
20	115	2260	0.52	2106	0.76
30	74	2220	1.72	1359	1.73
40	27	1080	2.20	557	1.94
<b>16" x 16" Euro Box Truss Weight Loading Info</b>					
10	300	3000		2300	
20	140	2800		1800	
30	53.3	1600		750	
40	22.5	900		500	

Connection: 3/8" Dia. x 1-1/4" Grade 5 Bolts

12"x12" Weight Load Certified By Structural Engineer

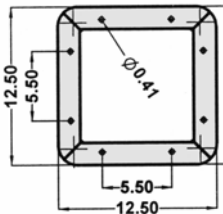

Front View

Side View

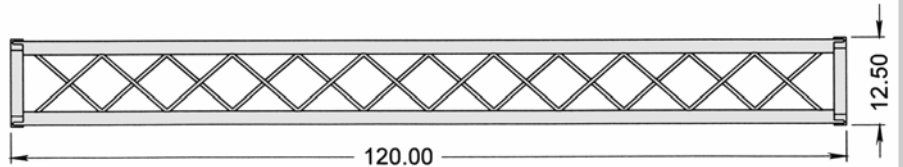

Standard Corner

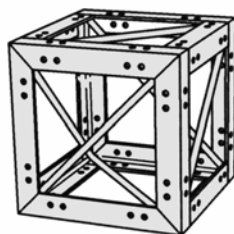

Custom Corner

